

MOVEMENT DETECTORS

PIR motion sensor ST16C

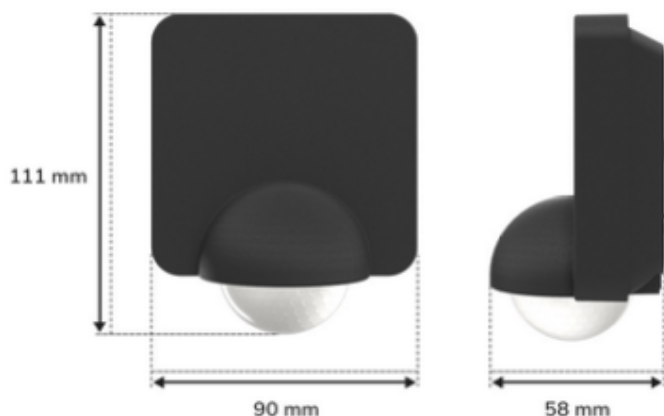

Producer	STARLUX
Product Code	ST16C

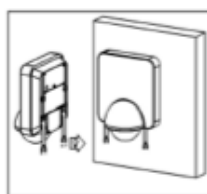
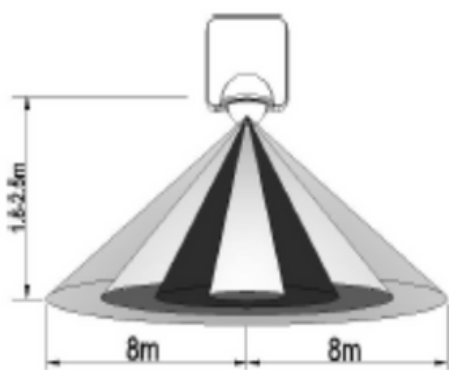

Flat mounted

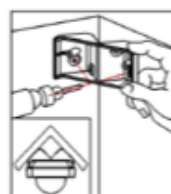

Inner corner mounted

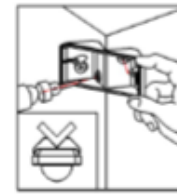

Outer corner mounted

Technical specification

Sensor type	PIR Sensor	Detection distance	8 m
IP rating	IP54	Detection of moving speed	0.6 - 1.5 m/s
Delay time	10s - 15 min	Color	black
Ambient Light	3 - 2000 lx	Input Power	220-240V AC
Operating temperature	-20 + 40 C	Beam angle	360
Material	Plastic	Maximum load	1200 W