

Technical data sheet

UP Flush-mounted device box 66

Item no. 2003702



Flush-mounted device box, for use in masonry with an installation depth of at least 66 mm.

- 4 x 3 screw domes
- Connector with bayonet lock, couplable on both sides
- 6 combination pipe entries of Ø 20 and 25 mm
- 2 entries up to Ø 20 mm
- 2 entries up to Ø 14 mm
- 1 entry up to Ø 20 mm in the base



PP Polypropylene

Master data

Item no.	2003702
Type	UG 66
Description 1	UP Flush-mounted device box
Available from	01.10.2021
Dimension	Ø60mm, H66mm
Colour	Jet black
Material	Polypropylene
Material symbol	PP
Smallest sales unit (VG)	25 Piece
Weight	2,39 kg/100 pc.

Technical data

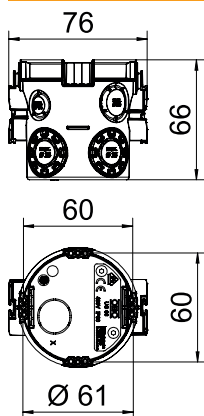

Height	66,00 mm
Diameter	60,00 mm
No. of entries	11
Entries	11
Type of housing penetration	Break-out opening
Version for	Single
Shape	Device connection box
Device fixing	Screws or spreading claws
Cover	Without
Cover fastening	Screws ,
Entry from rear	<input checked="" type="checkbox"/>
Flame-resistant	acc. to VDE 0471/IEC 60695-2-11, test temperature 650°C
Shape	Round
For pipe diameter	20/25 mm
Pipe entries Ø 20 mm	3
Combination entries Ø 20 / 25 mm	6
Halogen-free	<input checked="" type="checkbox"/>
With nail strap	<input type="checkbox"/>
With bolts	<input type="checkbox"/>
Mounting type	Concealed
Nominal cross section	1,50 - 2,50 mm²
Rated voltage	400,00 V
Impact-resistant	<input checked="" type="checkbox"/>

Technical data sheet

UP Flush-mounted device box 66



Item no. 2003702

Technical data

Protection rating	IP30
Airtight	<input type="checkbox"/>

Table 1



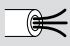
				
	1,5 mm ²	2,5 mm ²	1,5 mm ²	2,5 mm ²
	5	4	7	5
	15	12	21	15

Table 1